

JFBB 自润滑翻边轴套
JFBB Metric Flange Bearing

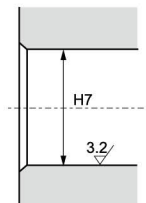
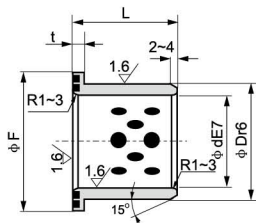
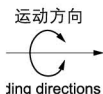

Mating Housing
相配座孔

内径 E7 I.D. Ø d		外径 r6 O.D. Ø D		翻边 Flange		长度 L ^{-0.1} _{-0.3}														
				Ø F	t	10	11	12	13	15	18	20	23	25						
6	+0.032 +0.020	10	+0.028 +0.019	20	3	0610	0611	0612												
8	+0.040 +0.025	12	+0.034 +0.023	25				0812	0813	0815										
10		14		25					1013	1018										
12	+0.050 +0.032	18	+0.041 +0.028	30			1211			1218	1223									
13		19		30				1313	1318	1323										
15		21		35				1513	1518	1523										
16		22		35		0			1613	1618	1623	1625								
18		24		40		0 -0.03				1818	1823									
20	+0.061 +0.040	28	+0.050 +0.034	45									2020	2025						
25		33		50			5							2520	2525					
30		38		55								3020	3025							
35		44		65								3520	3525							
40	+0.075 +0.050	50		70	7															
50		62	+0.060 +0.041	90	8															
60		74	+0.062 +0.043	110																
70	+0.090 +0.060	85	+0.073 +0.051	120	10															
80		96		140																

JFBB 自润滑翻边轴套
JFBB Metric Flange Bearing

Material	650 #+Graphite
材质	高力黄铜+石墨

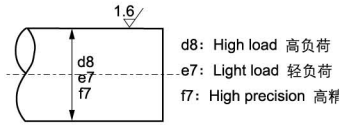

Mating Shaft
相配轴

单位unit:mm

长度 L $^{+0.1}_{-0.3}$											压装后内孔 I.D. After Press- Fitting	内径 d	
27	35	37	38	47	48	50	58	60	68	80	90	+0.016 +0.004	6
												+0.021 +0.006	8
												+0.031 +0.013	10
												+0.037 +0.016	12
												+0.026 +0.008	13
													15
													16
													18
												+0.037 +0.016	20
												+0.032 +0.011	25
	3035											+0.046 +0.021	30
	3535												35
4027		4037		4047								+0.040 +0.015	40
			5038		5048		5058						50
			6038		6048		6058		6068			+0.053 +0.023	60
						7050				7080			70
								8060			8090	+0.046 +0.016	80