

DIN9834 自润导套 DIN9834 Oilless Guide Bearing

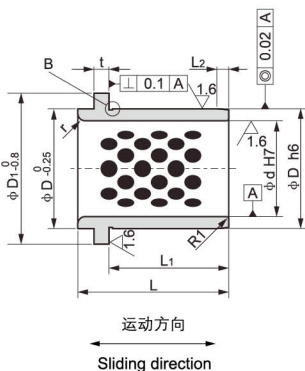

Material	650 # + Graphite
材质	高力黄铜 + 石墨

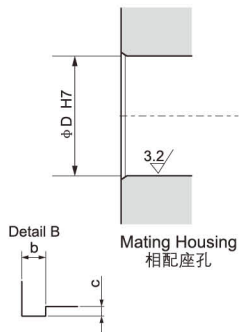

单位unitmm

型号规格 Standard No.	d H7		D h6		L	D ₁	L ₁	L ₂	t	r	bxc	P
DIN9834-025	25	^{+0.021} / ₀	32		40	40	30	3	6.3	3	0.6x0.3	58
DIN9834-032	32		40	⁰ / _{-0.016}	50	50	40	4				66
DIN9834-040	40	^{+0.025} / ₀	50		63	63	50	5				79
DIN9834-050	50		63	⁰ / _{-0.019}	71	71	56	6.3				89
DIN9834-063	63		80		80	90	63	8	10	6	1.0x0.4	123
DIN9834-080	80	^{+0.030} / ₀	100	⁰ / _{-0.022}	100	112	80	10				143
DIN9834-100	100		125		125	140	106	12.5	10	10	1.0x0.4	168
DIN9834-125	125	^{+0.040} / ₀	160	⁰ / _{-0.025}	160	180	132	16				203
DIN9834-160	160		200	⁰ / _{-0.029}	200	220	170	16	18	243		

Clamp VDI-KL(DIN9834)

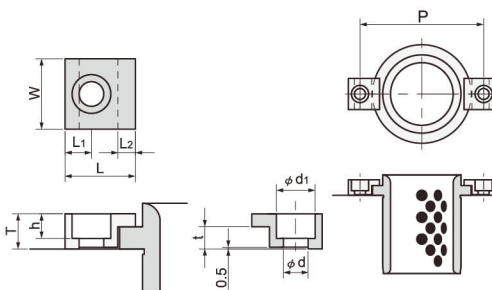

单位unitmm

型号规格 Standard No.	W	L	T	L ₁	L ₂	t	d	d ₁	h	适用的轴套内孔尺寸 Applicable bushes ID
VDI-KL-6	20	20	10	7.5	5	6.3	7	11	7	Ø25~Ø50
VDI-KL-10	32	32	16	11	10	10	11.5	17.5	11.5	Ø63~Ø160